

# TECHNICAL ADVISORS

1965-68 MUSTANG

Restoration Advisor:  
 Fred R. Glazier, Jr.  
 D. No. 1  
 Ardmore, Pa. 18964  
 (610) 723-9674

MUSTANG

Mechanical Advisor:  
 John Vermeersch  
 J & E Racing Engines  
 40631 Irvin  
 Mt. Clemens, Michigan  
 48045  
 (313) 468-FORD

MUSTANG

Features & Accessory  
 Advisor:  
 Alec J. Karacsony  
 75 Venta Drive  
 Northford, Connecticut  
 06472  
 Letters only

1969-73 MUSTANG

Restoration Advisor  
 Bill Dillard  
 108 Jones Ave.  
 Calhoun, Ga.  
 30701

ANGLE  
 UN  
 OOR  
 WINDOW  
 REGULATOR  
 SYSTEM  
 1971  
 MUSTANG

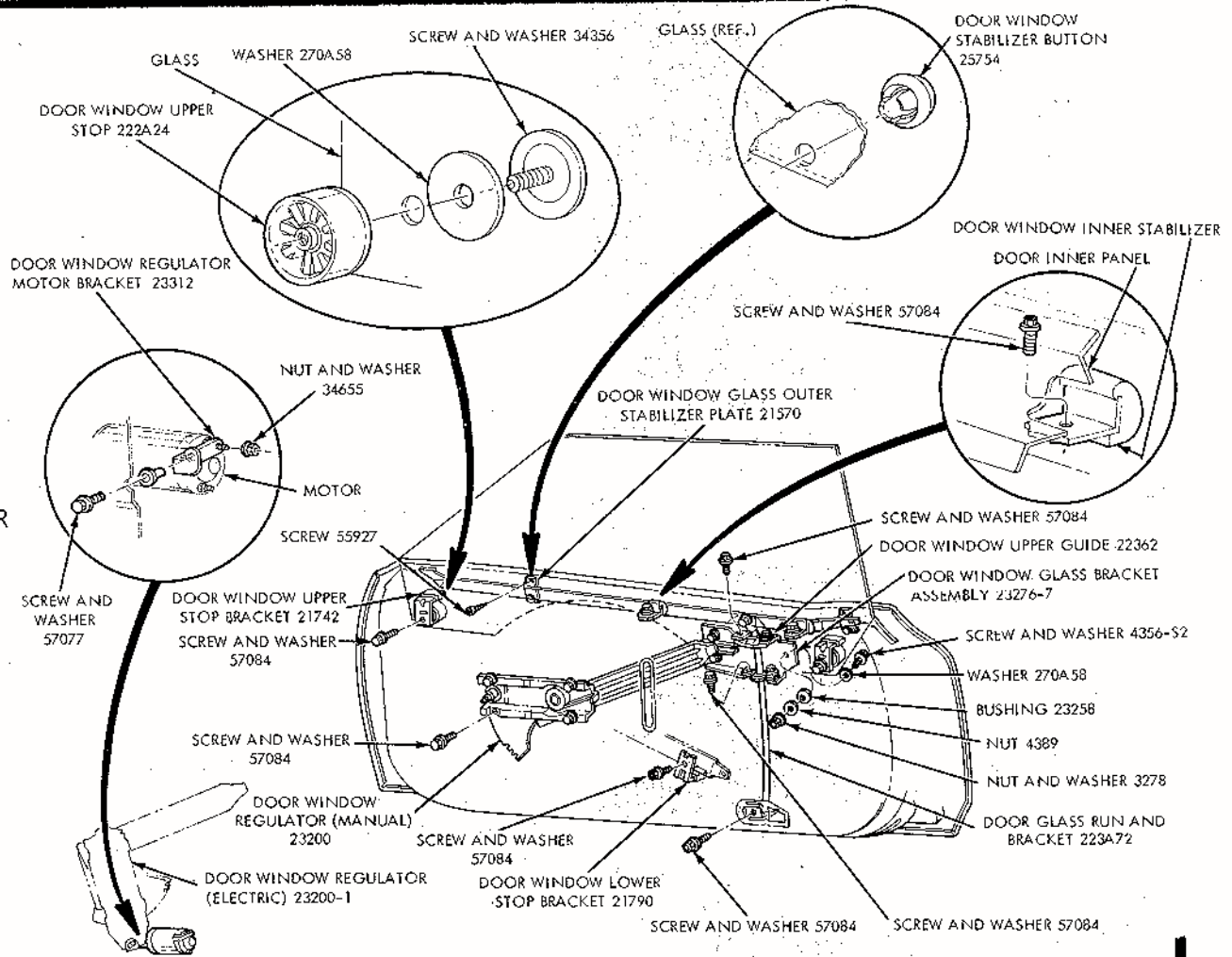

## 1969 MUSTANG PRODUCTION FIGURES

63A 2d FASTBACK	56,022
63B 2d FASTBACK DELUXE	5,958
63C 2d FASTBACK MACH I	72,458
65A 2d HARDTOP	118,613
65B 2d HARDTOP DELUXE	5,210
65C 2d HARDTOP (BENCH SEATS)	4,131
65D 2d HARDTOP DELUXE (BENCH SEATS)	504
65E 2d HARDTOP GRANDE	22,182
76A CONVERTIBLE	11,307
76B CONVERTIBLE DELUXE	3,439
TOTAL 1969 MUSTANG PRODUCTION	300,000

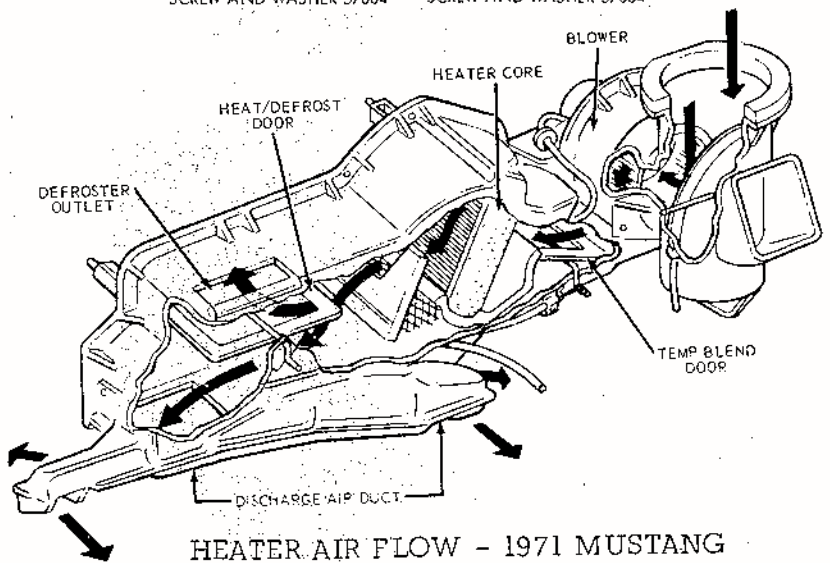

HEATER AIR FLOW - 1971 MUSTANG